

圖(一) 視廳室舞台尺寸資料

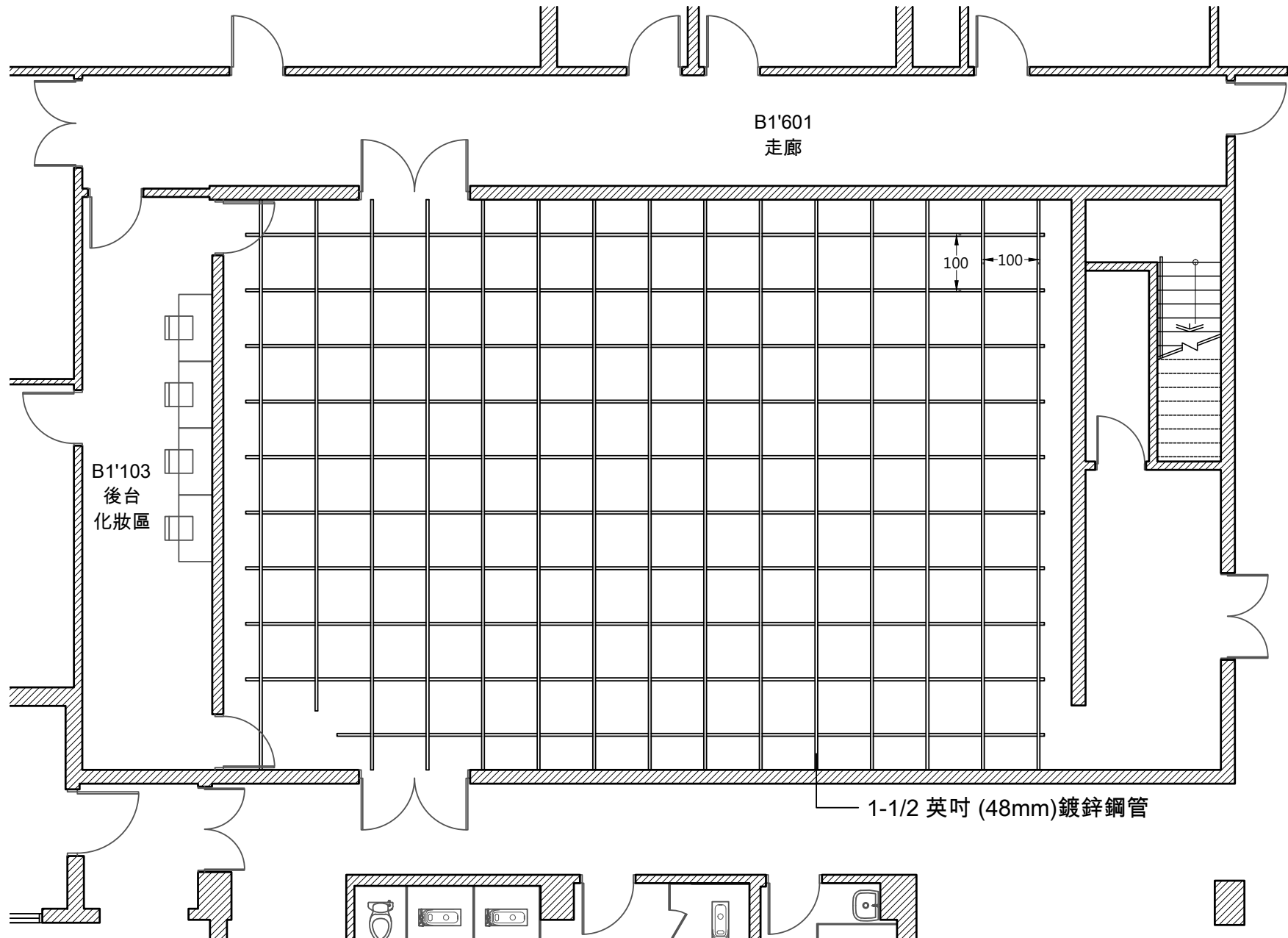

圖(二) 視廳室桁架尺寸資料

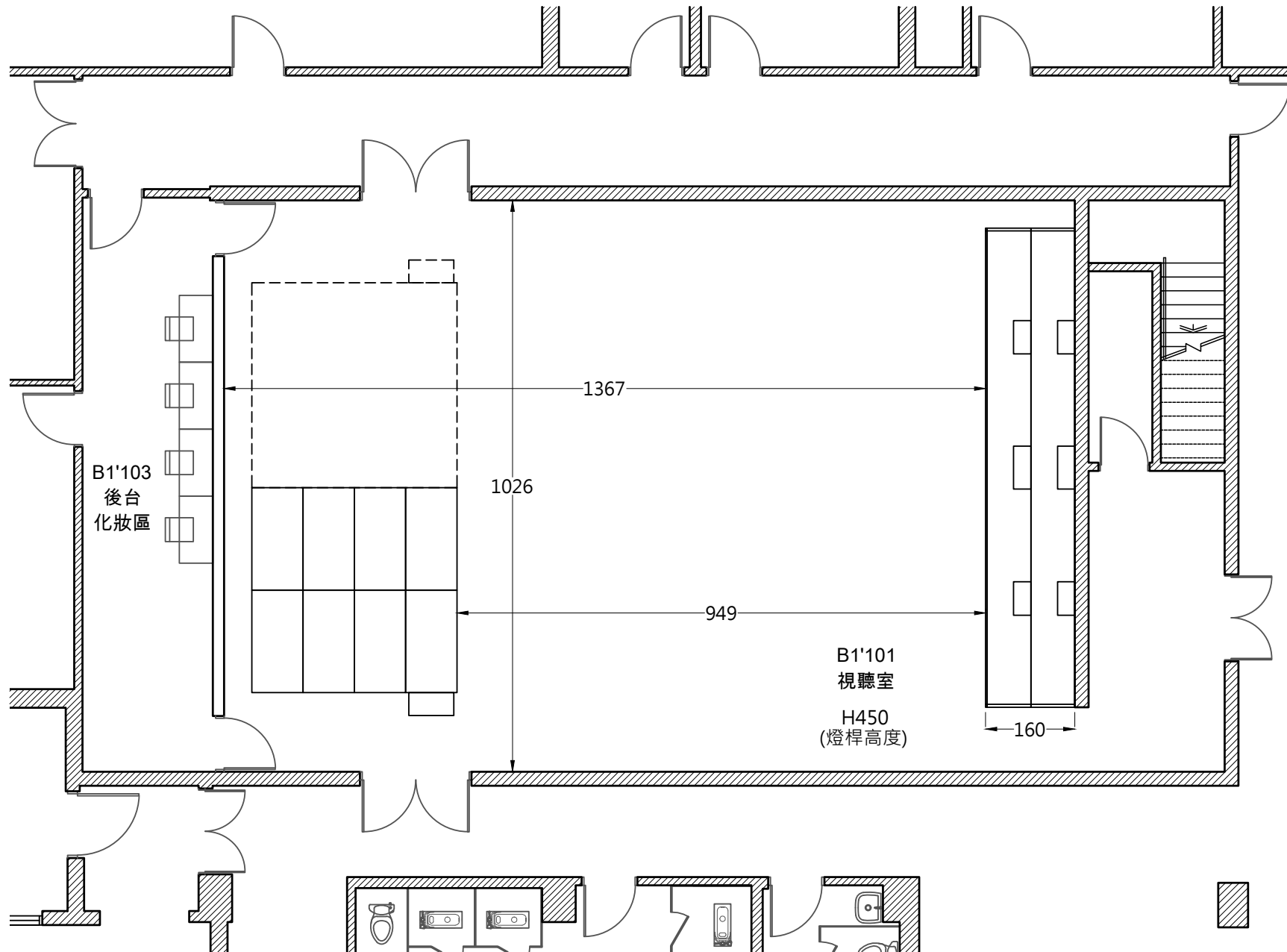

圖(三) 觀眾席平台收起時尺寸

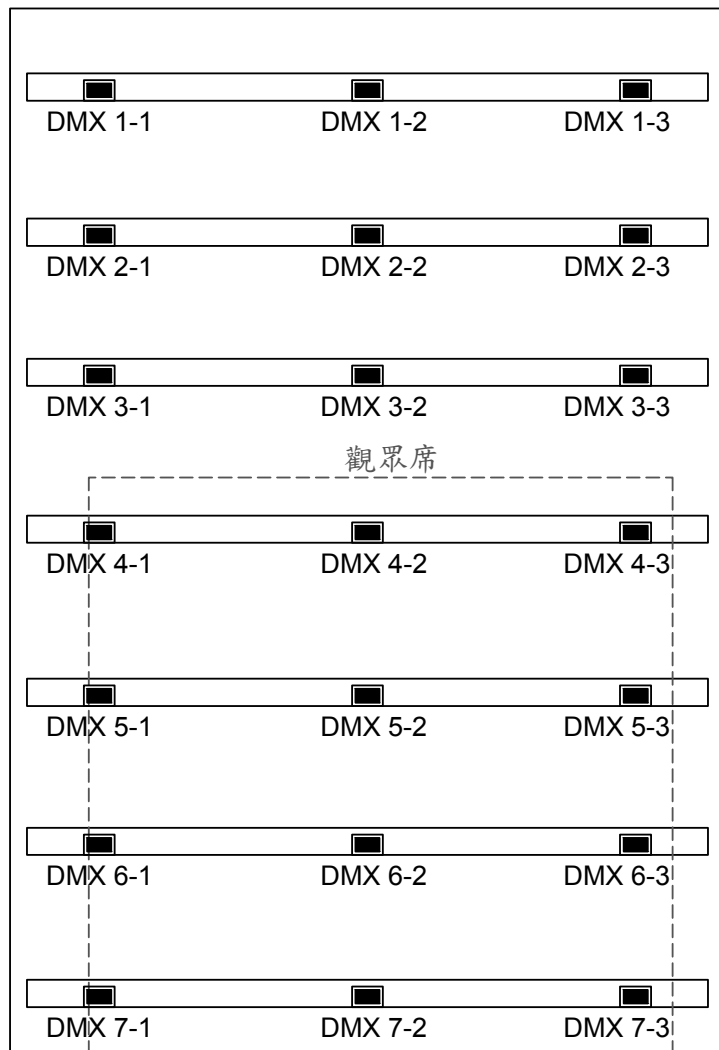

燈桿 1

燈桿 2

燈桿 3

燈桿 4

燈桿 5

燈桿 6

燈桿 7

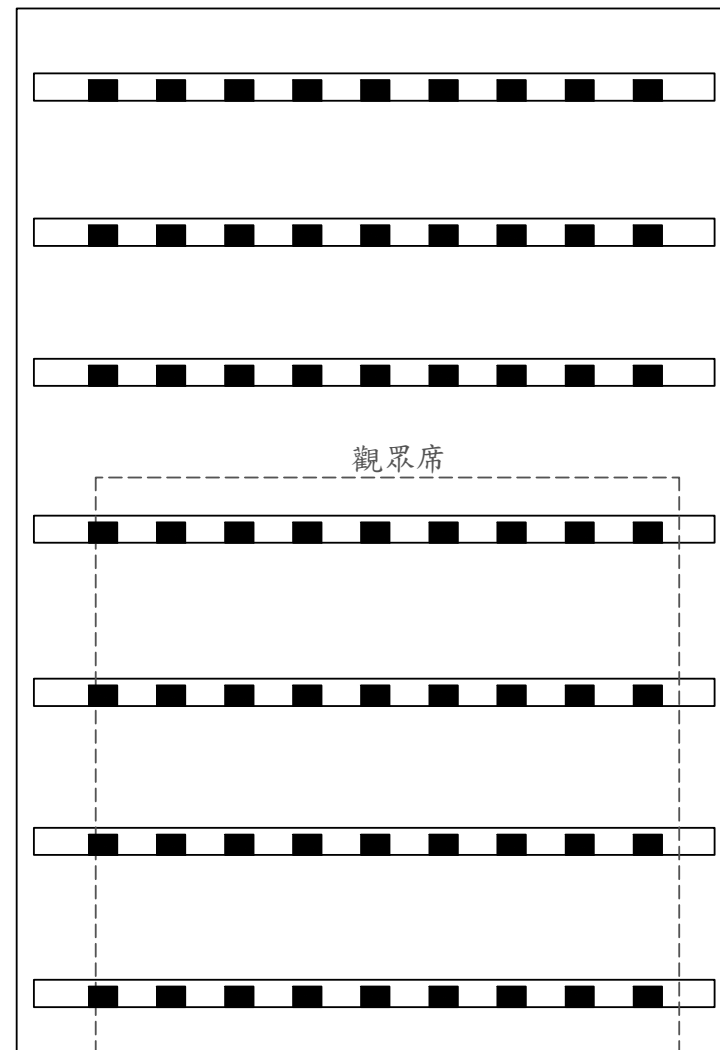

燈桿 1
20A

燈桿 2
20A

燈桿 3
20A

燈桿 4
20A

燈桿 5
20A

燈桿 6
20A





燈桿 7
20A

DMX 訊號孔位置圖

燈光直通電迴路位置圖

圖(四) 視聽室燈光訊號及迴路位置圖

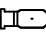
KEY

-  ACME XA-400 SPOT
-  ETC LED S2 Lustr CYC (模式: Direct)
-  TMM LED PAR
-  ETC LED S2 Lustr 36 (模式: Direct)
-  Channel No.

燈具Address No.對照表

Chan. No.	燈型	Address No.	Chan. No.	燈型	Address No.
21	ETC CYC	20 - 29	41	ETC LED 36	330 - 339
22	ETC CYC	30 - 39	42	ETC LED 36	340 - 349
23	ETC CYC	40 - 49	43	ETC LED 36	350 - 359
24	ETC CYC	50 - 59	44	ETC LED 36	360 - 369
25	ETC CYC	60 - 69	45	ETC LED 36	370 - 379
26	ETC CYC	70 - 79	46	ETC LED 36	380 - 389
27	ETC CYC	80 - 89	51	LED PAR	120 - 126
31	ACME SPOT	401 - 419	52	LED PAR	127 - 133
32	ACME SPOT	180 - 198	53	LED PAR	134 - 140
33	ACME SPOT	200 - 218	54	LED PAR	141 - 147
34	ACME SPOT	220 - 238	55	LED PAR	155 - 161
35	ACME SPOT	240 - 258	61	ACME SPOT	421 - 439
36	ACME SPOT	260 - 278	62	ACME SPOT	461 - 479
37	ACME SPOT	280 - 298	63	ACME SPOT	441 - 459
38	ACME SPOT	300 - 318	64	ACME SPOT	481 - 499

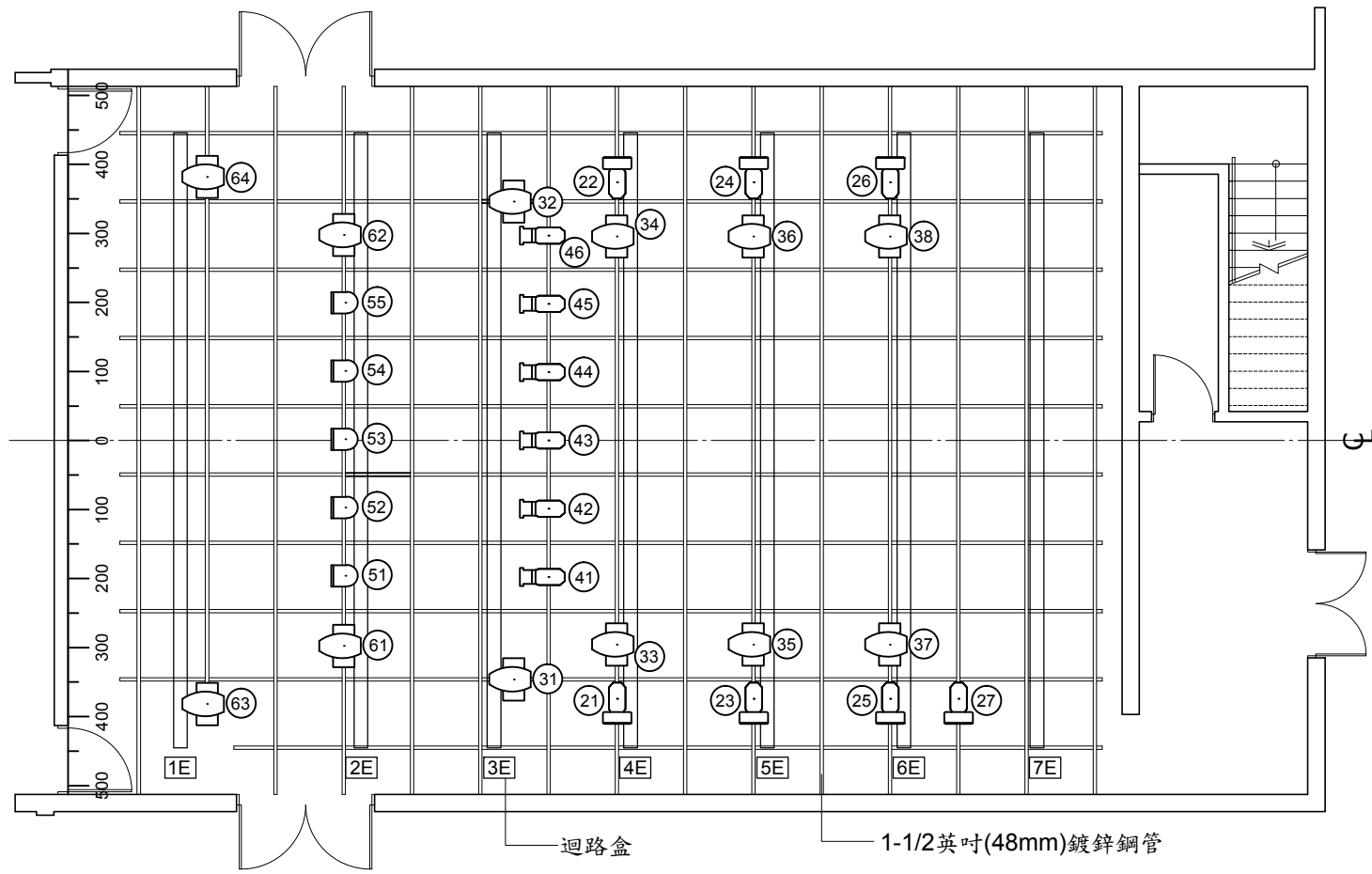

臺音館視聽室
燈具配置圖

單位：公分

圖 (五) 視聽室燈具配置圖

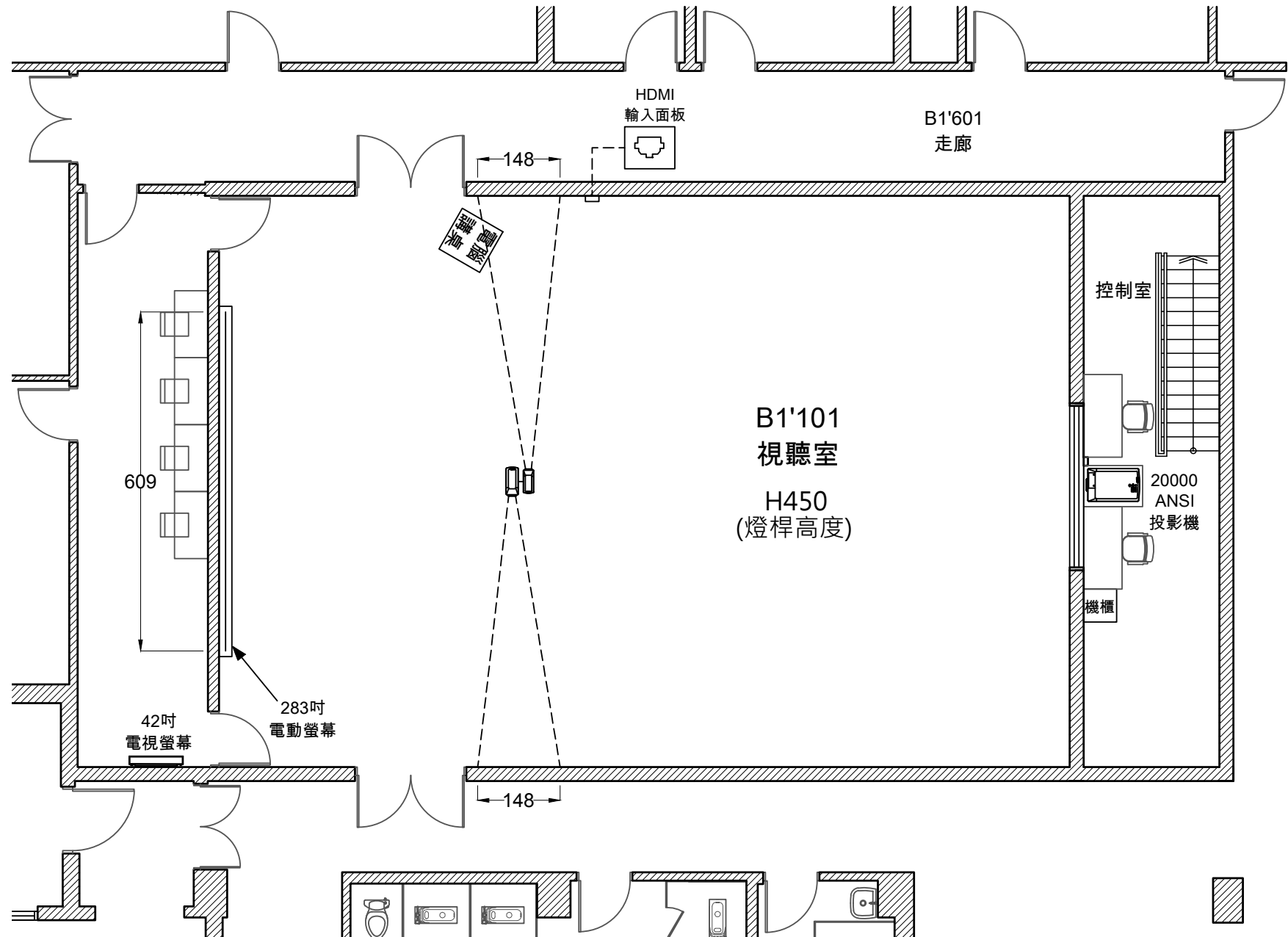

圖(六) 视听室视讯配置圖